

January 1978

95 c

Sunset

The Magazine of Western Living

Indoor Gardens Make News
in the Mountain States P 42

The Best "Noshing" in L.A.?
It's on Fairfax Avenue P 30

Great Year, Great Month
to Discover Death Valley P 54

Deck and connecting
patio of terraced gar-
are just outside the living ro
Overhanging bedroom balc
has boxy canopy to prov
additional shade
priv

Trade winds cool Honolulu award-winner. It's multilevel on a very steep site

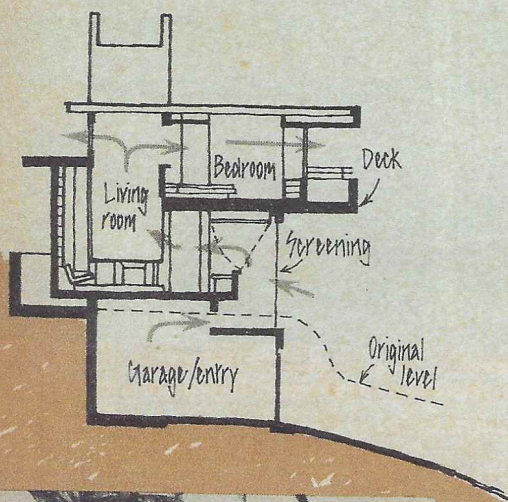

Suiting a house to its climate is a basic but often overlooked way to conserve energy as well as make rooms more comfortable to live in. Here is a *Sunset-AIA* award-winning house in Honolulu designed to take maximum advantage of cooling trade winds. The openness of the three interweaving levels makes this small, 1,500-square-foot house seem spacious and allows every breeze to move freely through it, as the gray arrows in the sketch indicate.

The site, with its steep 40° to 60° slope and splendid view, was part of a neighbor's terraced, subtropical garden. The vertical house design did the least damage to it, although one-third of the tight building budget went into concrete block foundations and retaining walls.

Windows along the view side of the living room are angled to prevent reflections from interfering with the magical

view of the city at night. When these windows are all opened, the room becomes a screened lanai.

The screening is set well out from the sloping windows and reaches down to the top of the garage—leaving an easy pathway for cool air from the garage to flow up into the living areas to replace warm air exiting at the top. A clerestory window high on the opposite living room wall encourages this flow, and also brings the gardened slope behind the house into the view of anyone in the upper bedroom level.

Economizing on many small items added up to substantial overall savings. For example, Chip Detweiler of Meyers, Detweiler, and Associates, Architects saved several hundred dollars by specifying exposed particle board for kitchen cabinetry and doors and designing simple built-in furniture. □

Living room shares luxury of space, light, and breezes with loft bedroom. Door to deck opens near fireplace. Tall, narrow window at left balances light, and its vertical jalousies open for ventilation. Below right, angled living room windows lift up; screening is directly beyond them.

GLENN CHRISTIANSEN

